

# Multiway ball valve combinations 3KH, 4KH

## Steel

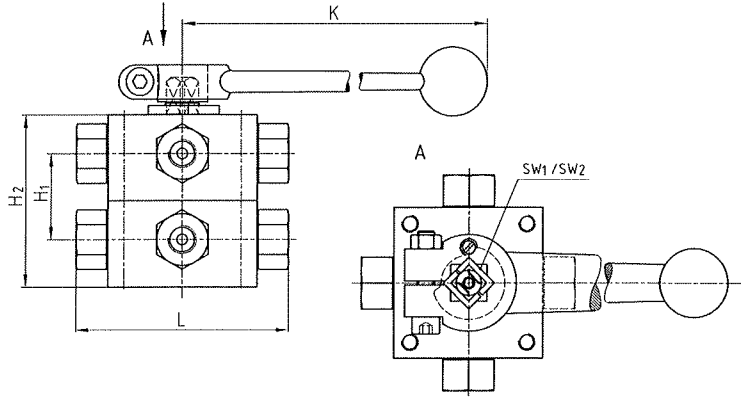
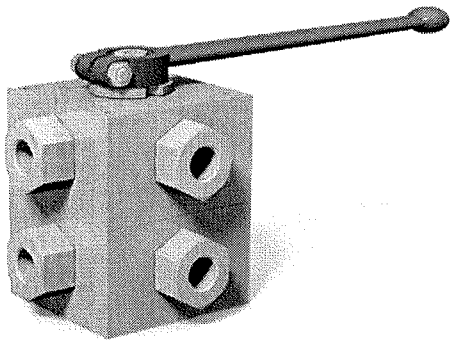

Detailed dimensions:  
Catalog page 108 to 110 and 116 to 118

**SW<sub>1</sub>**: Wrench size of trunnion ball  
**SW<sub>2</sub>**: Wrench size of lever

### AVAILABLE SIZES

DN4 - DN25 (1/8" to 1")

### CONNECTIONS

DIN ISO 228 Female thread, ANSI B1.20.1 NPT Female thread, DIN 2353/ISO 8434-1 Light / Heavy series, SAE J 514/ISO/DIS11926-1 Female thread, others on request

### ACCESSORIES ON REQUEST

- Locking devices page 222 - 225
- Actuators 220 - 221
- Mounting holes on request
- Position switches on request
- Detent 231

### MATERIAL CODE DESCRIPTION

Materials	112A	112A
Body	Steel	Steel
Trunnion ball	Steel	Steel
Ball seats	POM	POM
O-rings	NBR	NBR
Tmin / Tmax	-20°C / 100°C	-20°C / 100°C
Porting pattern	L=SB01	T=SB13
Type	3KH	4KH

### GENERAL DIMENSIONS

Type	SW <sub>1</sub>	SW <sub>2</sub>	H <sub>1</sub>	H <sub>2</sub>	K	Lever
3/4KH-DN4	12	17	40	80	320	Al
3/4KH-DN6	12	17	40	80	320	Al
3/4KH-DN8	14	17	50	100	320	Al
3/4KH-DN10	14	17	50	100	320	Al
3/4KH-DN13	14	17	60	120	320	Al
3/4KH-DN16	14	17	60	120	320	Al
3/4KH-DN20	17	17	67	134	320	Al
3/4KH-DN25	17	17	82	164	320	Al
3/4KH-DN25/32	17	17	82	164	320	Al
3/4KH-DN25/40	17	17	82	164	320	Al

### PORTING PATTERNS



Further porting patterns page 262 to 267