

Cabinet Top Ventilator

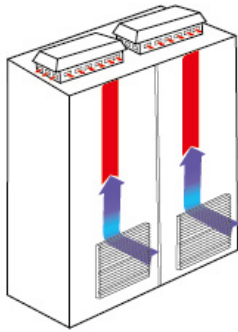

Certification	Material	Retardent Rating	IP Rating
CE	ABS/Steel	UL94-V2	IP53

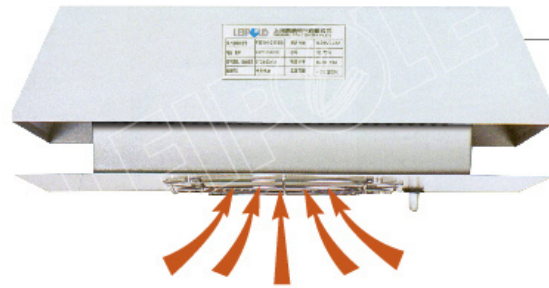

First generation
F2E190-230-DS
F2E 220-230-DS
F2E 225-230-DS



Second generation
F2E190-230-DP
F2E 220-230-DP
F2E 225-230-DP

Introduction of foreign advanced technology, our company research and development on top of the cabinet exhaust fan, this product is a patent product.

Internal

Using the exhaust fan on top is a prerequisite: the ambient temperature is lower than the required temperature within the cabinet.

Features

Powerful centrifugal exhaust fan on top of the main to the discharge of heat load for maximum efficiency. Can avoid using centrifugal fan blower exhaust ordinary magnetic shielding properties of the formation of the cyclone vortex, but also reduce the friction between air and noise. FK series of air inlet ventilation using cascade, to prevent moisture and dust from entering.

Design

Centrifugal exhaust fan on top of unique, beautiful, good function, the structure is more reasonable, do not take up interior space, through its unique design so that it can best apply the requirements of the market today.

Dimensions

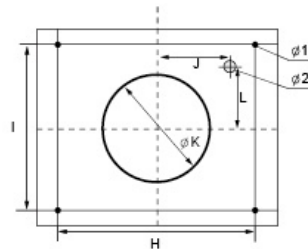

Top cabinet opening Fig

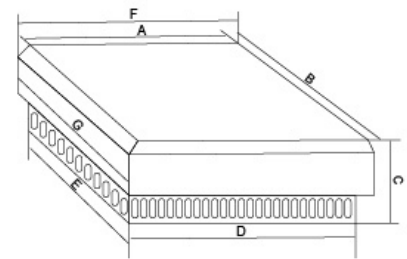

Model	Order number	A/B	C	D/E	F/G	H/I	J	ΦK	Φ1	Φ2	L
F2E190-230-DS	2017.001	310/295	125	375/330	375/315	358/308	100	158	7.8	10	100
F2E 220-230-DS	2017.002	310/295	125	375/330	375/315	358/308	100	158	7.8	10	100
F2E 225-230-DS	2017.003	310/295	125	375/330	375/315	358/308	100	158	7.8	10	100

Model	Order number	A/B	C	D/E	F/G	H/I	J	ΦK	Φ1	Φ2	L
F2E190-230-DP	2017.004	270	130	267	310	226.8	98.4	195	7.8	15	97
F2E 220-230-DP	2017.005	270	130	267	310	226.8	98.4	195	7.8	15	97
F2E 225-230-DP	2017.006	270	130	267	310	226.8	98.4	195	7.8	15	97

Technical data

Model	F2E190-230-DS/P	F2E220-230-DS/P	F2E225-230-DS/P
Rated voltage (V / Hz)	230/50/60		
Air flow, free blowing	570/620m ³ /h	860/900m ³ /h	1200/1340m ³ /h
Air flow With exit filters	1xFK6626.300 456/496m ³ /h	1xFK6626.300 688/540m ³ /h	1xFK6626.300 960/1072m ³ /h
Axial Fan	Electric capacitance		
Rated current (A)	0.26/0.34	0.38/0.40	0.60/0.88
Power (W)	58/75	85/90	135/200
Noise level (dB)	62/64	69/71	73/74
Operating temperature range	-10°C to +55°C		-10°C to +60°C
Remarks	The number of air inlet filter, size according to the specific circumstances.		

Power curve F2E....

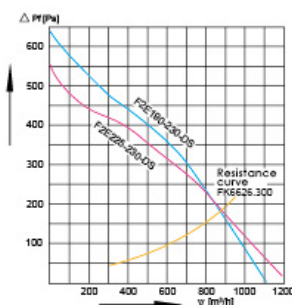

Cabinet Exhaust Fan

F2E new generation of Cabinet top ventilator

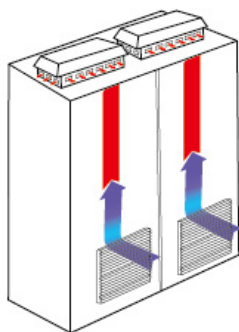

Certification	Material	Retardent Rating	IP Rating
CE	ABS/Steel	UL94-V2	IP53



LEIPOLE

Introduction of foreign advanced technology, our company research and development on top of the cabinet exhaust fan, this product is a patent product.

Internal

Using the exhaust fan on top is a prerequisite: the ambient temperature is lower than the required temperature within the cabinet.

Features

Powerful centrifugal exhaust fan on top of the main to the discharge of heat load for maximum efficiency. Can avoid using centrifugal fan blower exhaust ordinary magnetic shielding properties of the formation of the cyclone vortex, but also reduce the friction between air and noise. FK series of air inlet ventilation using cascade, to prevent moisture and dust from entering.

Design

Centrifugal exhaust fan on top of unique, beautiful, good function, the structure is more reasonable, do not take up interior space, through its unique design so that it can best apply the requirements of the market today.

Patent No. 1474456

Dimensions

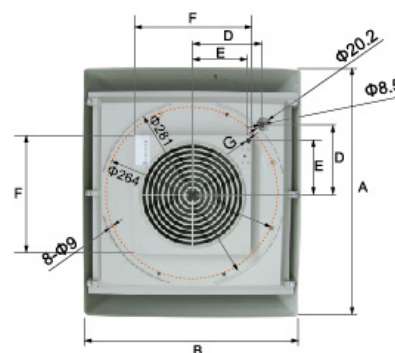
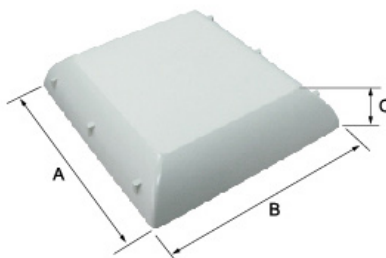

Model	A	B	C	D	E	F	G
F2E190-230-DSP	400	350	103	107.2	83.85	179.5	Φ7
F2E 220-230-DSP	400	350	103	107.2	83.85	179.5	Φ7
F2E 225-230-DSP	400	350	103	107.2	83.85	179.5	Φ7

Power curve F2E....

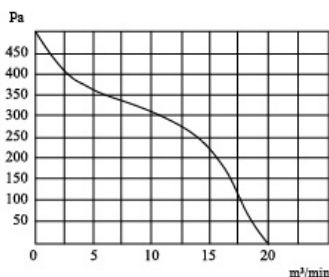

Technical data

Model	F2E190-230-DSP	F2E220-230-DSP	F2E225-230-DSP
Order number	2017.007	2017.008	2017.009
Rated voltage (V / Hz)	230/50/60		
Air flow, free blowing	570/620m³/h	860/900m³/h	1200/1340m³/h
Air flow With exit filters	1xFK6626.300 456/496m³/h	1xFK6626.300 688/540m³/h	1xFK6626.300 960/1072m³/h
Axial Fan	Electric capacitance		
Rated current (A)	0.26/0.34	0.38/0.40	0.60/0.88
Power (W)	58/75	85/90	135/200
Noise level (dB)	62/64	69/71	73/74
Operating temperature range	-10°C to +55°C		-10°C to +60°C
Remarks	The number of air inlet filter, size according to the specific circumstances.		